

HOLMAN

Wi-Fi HUB + WX1

Wi-Fi Controlled
Hub Socket
with Tap Timer



www.holmanindustries.com.au

User Guide

Contents

Overview	4
WX1 Tap Timer Components	4
WX1 Tap Timer Features	5
Wi-Fi Hub and Power Socket Components	6
Wi-Fi Hub and Power Socket Features	6
LED Status	7
Installation	8
Installing Holman Home	8
Add the Wi-Fi Hub to Holman Home in AP Mode	9
Add the Wi-Fi Hub to Holman Home in EZ Mode	14
Add the WX1 to Holman Home	16
Operation	18
WX1 Tap Timer Manual Operation	18
Wi-Fi Hub and Socket Manual Operation	20
Wi-Fi Hub and Socket Schedules	22
WX1 Tap Timer Schedules	24
WX1 Tap Timer Smart Automations	27
Additional Notes	28
Low Battery Notification	28
Maintenance	29
Cold Weather	29
Batteries	29
Connection Issues	29
Warranty	30

Overview

WX1 Tap Timer Components

1. 20/25mm BSP reducing bush
2. 25mm tap adaptor
3. **TAP TIMER BUTTON**
4. Watering indicator
5. 20mm BSP outlet
6. 12mm snap-on hose fitting
7. Battery compartment: requires 4× AA alkaline batteries only

⚠ Do not mix old and new batteries



Model no: WX1TH

Overview

WX1 Tap Timer Features

- ✔ Set and check watering schedules from **Holman Home** on your smartphone, anywhere internet access is available
- ✔ IP54 dust and water protection rating
- ✔ 30-1200 kPa working pressure
- ✔ 3°C-50°C working temperature
- ✔ Maximum flow rate 35 L/min
- ✔ **⚠ For use with cold water only**
- ✔ Works with the **HOLMAN Smart Moisture Sensor [WXMS - sold separately]** to record and automate schedules based on soil moisture
- ✔ Built-in flow meter. The minimum system output for flow readings is 7 L/min. Pressure compensating and low output systems may not report flow.
- ✔ **WATER** and **MIST** modes for different watering functions
- ✔ Low battery indicator

Smart
Moisture



Know your garden better than ever by connecting a Smart Water Sensor. This keeps track of soil temperature and moisture, and allows for automatic water restrictions based on moisture sensitivity.



SCAN FOR MORE INFO



Overview

Wi-Fi Hub and Power Socket Components

1. **Wi-Fi Hub** provisioning button
2. **Wi-Fi Hub** green LED indicator
3. AC power plug
4. **Wi-Fi Socket**



Wi-Fi Hub and Power Socket Features

- ✔ Use the Wi-Fi power socket to control a nominated power outlet from **Holman Home**
- ✔ Pair up to 4x additional **HOLMAN WX Tap Timers**
- ✔ 917 MHz RF communication between **Wi-Fi Hub** and **WX1 Tap Timer**—50m line-of-sight range
- ✔ 2.4 GHz Wi-Fi connection only
- ✔ For indoor use only, and must be within Wi-Fi network range

Overview

LED Status

WX1 Tap Timer

- ✔ **OFF:** Valve is closed
- ✔ **WHITE QUICK FLASH:** Ready for pairing to a **Wi-Fi Hub**
- ✔ **WHITE SLOW FLASH:** Searching for a **Wi-Fi Hub**
- ✔ **RED INTERMITTENT FLASH:** Low battery warning
- ✔ **RED PULSE:** Water leak when valve is closed
- ✔ **RED:** When searching for a **Smart Moisture Sensor**; cannot find

Wi-Fi Hub and Power Socket

- ✔ **OFF:** Power socket is off
- ✔ **GREEN:** Power socket is on
- ✔ **GREEN FLASH:** **Wi-Fi Hub** is ready for pairing with Wi-Fi



Our single outlet **WX1 Wi-Fi Tap Timers** are the perfect companion to your **Wi-Fi Hub**. Water all around your garden from **Holman Home**.



SCAN FOR MORE INFO

Installation

Installing Holman Home

1. Download **Holman Home** to your mobile device via the **App Store** or **Google Play**
2. Open **Holman Home** on your mobile device
 - i** You may be prompted to allow notifications—the app can still function if you choose to opt out
3. Tap **SIGN UP**
4. Read our User Agreement and Privacy Policy and tap **AGREE** if you wish to proceed
5. Follow the prompts to register a **Holman Home** account with your email address
 - !** **Ensure your country details are correct at this stage**
 - i** You may be prompted to allow access your location. This allows the app to show weather information—it will still function if you choose to opt out

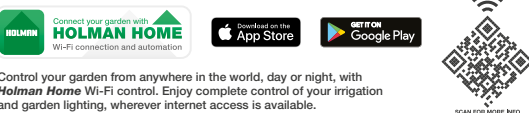

Connect your garden with **HOLMAN HOME** Wi-Fi connection and automation

Available on the **App Store** | **GET IT ON Google Play**

Control your garden from anywhere in the world, day or night, with **Holman Home** Wi-Fi control. Enjoy complete control of your irrigation and garden lighting, wherever internet access is available.

SCAN FOR MORE INFO

Installation

Add the Wi-Fi Hub to Holman Home in AP Mode

1. Turn off your mobile data
2. Plug your **Wi-Fi Hub** into a power source near your Wi-Fi router
3. Open **Holman Home** and add a new device by tapping **+** [a] on the **HOME** screen
5. Enter your Wi-Fi network [d] and password [e], then tap **NEXT** [f]

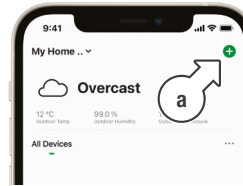

4. Tap **GARDEN WATERING** [b] and choose **Wi-Fi HUB** [c]

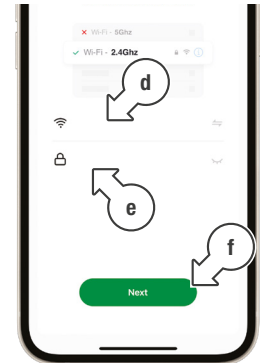
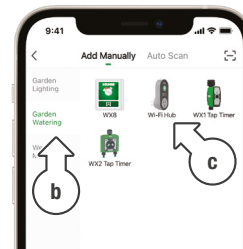

6. On the following screen, tap **EZ MODE** [g]



Installation

Add the Wi-Fi Hub to Holman Home in AP Mode (continued)

7. From the drop-down menu, tap **AP MODE** [h]



8. Reset the **Wi-Fi Hub** as per the instructions provided on-screen [i]
9. Once the **Wi-Fi Hub** is flashing accordingly, check the LED confirmation toggle [j] and tap **NEXT** [k]

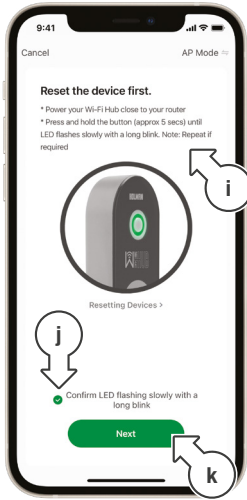

- i** The Wi-Fi Hub has three flashing modes:
- Fast flash
 - Slow flash
 - Short flash, long pause

Installation

Add the Wi-Fi Hub to Holman Home in AP Mode (continued)

10. On the following screen, tap **GO TO CONNECT** [l]

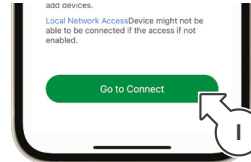

11. **Apple iOS only:** If redirected to **SETTINGS**, tap **Wi-Fi** [m]

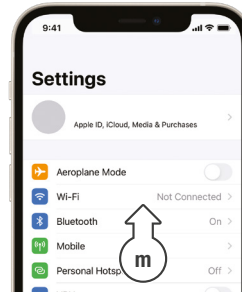

12. **Apple iOS only:** Tap **Holman-WX-XXXX** [n] and wait until the network is connected (without internet)

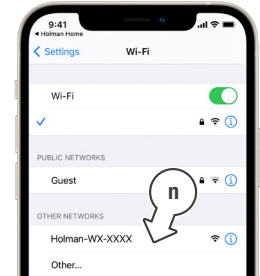

13. **Android only:** Tap the **Holman-WX-XXXX** [o] and wait until the network is connected (without internet)

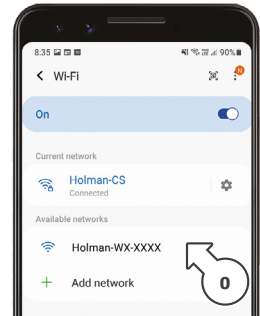

Installation

Add the Wi-Fi Hub to Holman Home in AP Mode (continued)

i **Apple iOS or Android:** If the **Holman-WX-XXXX** network does not show in your Wi-Fi settings, try the following:

✔ Disable Wi-Fi on your smartphone, wait a few moments and turn Wi-Fi back on

✔ You may need to reset your **Wi-Fi Hub** again; Hold the button for approximately 5 seconds to change to fast-flash mode, then hold the button again for approx 5 seconds to change back to slow-flash mode

14. **Android only:** It will show **Internet may not be available**, choose **Connect only this time** [p]



15. **Pixel:** It will show **Network has no internet**, choose **YES** [r], you will now be connected

i Once you are **CONNECTED WITHOUT INTERNET** tap the Pixel Back Button ◀ [r] to return to **Holman Home**



Installation

Add the Wi-Fi Hub to Holman Home in AP Mode (continued)

16. **Apple iOS only:** Once **Holman-WX-XXXX** is the active network [t], return to **Holman Home** by tapping the **Holman Home** shortcut [u]

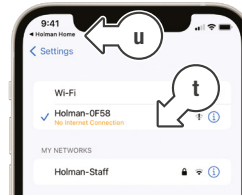

i The active network will appear with **“No Internet Connection”**

17. **Apple iOS or Android:** Click **“Confirm hot spot connection, next”** underneath the **RECONNECT** button [v]

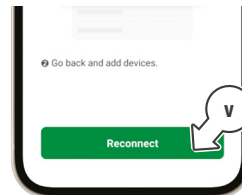

18. Wait until the pairing process [w] is completed.

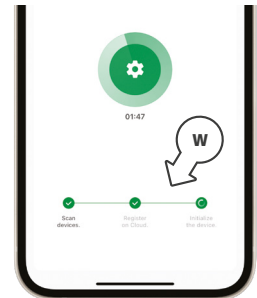

19. When your **Wi-Fi Hub** [x] connects successfully, tap **DONE** [y]

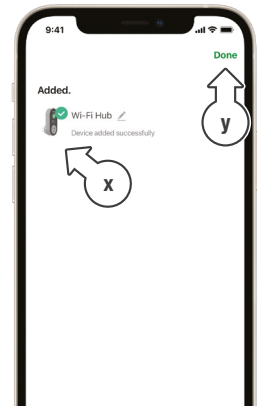

Installation

Add the Wi-Fi Hub to Holman Home in EZ Mode

1. Plug your **Wi-Fi Hub** into a power source near your Wi-Fi router
2. Open **Holman Home** and add a new device by tapping **+** [a] on the **HOME** screen

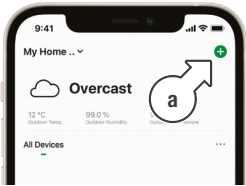

3. Tap **GARDEN WATERING** [b] and choose **Wi-Fi HUB** [c]

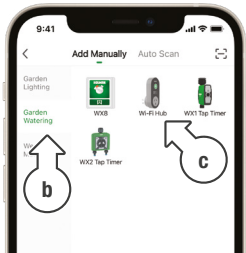

4. Enter your Wi-Fi network [d] and password [e], then tap **NEXT** [f]

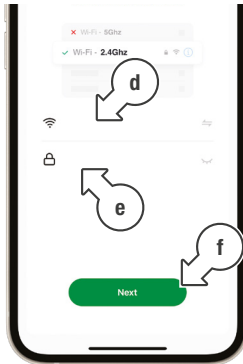

5. Reset the **Wi-Fi Hub** as per the instructions provided on-screen [g]
6. Once the **Wi-Fi Hub** is flashing accordingly, check the LED confirmation toggle [h] and tap **NEXT** [i]

Installation

Add the Wi-Fi Hub to Holman Home in EZ Mode (continued)

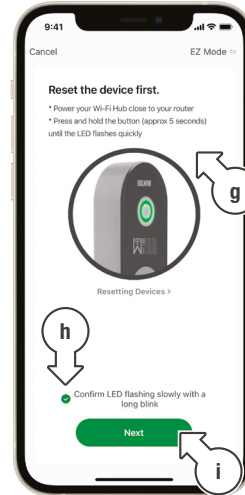

- i** The Wi-Fi Hub has three flashing modes:
- Fast flash
 - Slow flash
 - Short flash, long pause

7. Wait until the pairing process [j] is completed.

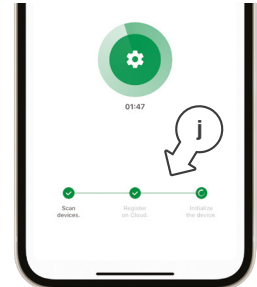

8. When your **Wi-Fi Hub** [k] connects successfully, tap **DONE** [l]

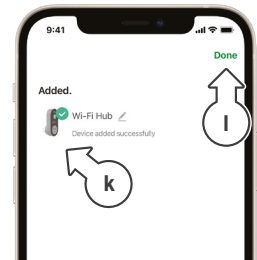

Installation

Add the WX1 to Holman Home

1. Ensure your **WX1 Tap Timer** is close to your **Wi-Fi HUB** and install **4x 1.5v AA alkaline batteries** [a]
2. From the **HOME** screen tap **+** [b] to add the **WX1 Tap Timer** and **Wi-Fi Socket**



2. From the **HOME** screen tap **+** [b] to add the **WX1 Tap Timer** and **Wi-Fi Socket**



3. Tap **GARDEN WATERING** [c] and choose **WX1 Tap Timer** [d]. When a **GATEWAY** [e] is requested, select **Wi-Fi HUB** [f]

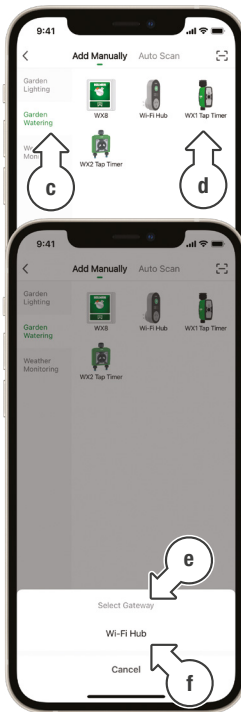

Installation

Add the WX1 to Holman Home (continued)

4. Reset the **WX1 Tap Timer** as per the instructions provided on-screen [g]
5. Once the **WX1 Tap Timer** is flashing fast, check the **LED** confirmation toggle [h] and tap **NEXT** [i]

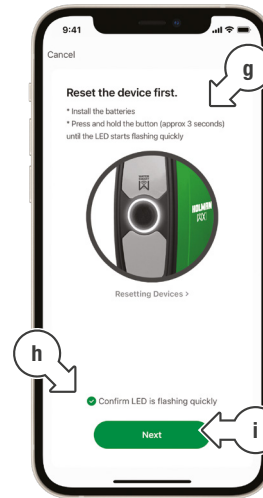

6. Select **ADD ALL** to ensure both, **WX1 Tap Timer** and **Wi-Fi Socket** are added before tapping **DONE**.

For any subsequent timers there is only 1 device being added, ensure the message reads 'device added successfully' before hitting done (tap the blue circle if needed)

7. Wait until both the **WX1 Tap Timer** [j] and **Wi-Fi Socket** [k] have been added, then tap **DONE** [l]

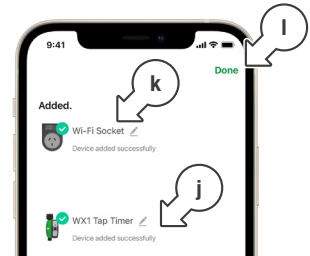

7. If your **WX1 Tap Timer** is already connected to your tap and has been tested prior to pairing, remove the batteries for 1min to reset. If the **WX1 Tap Timer** is not close to the **Wi-Fi HUB**, take it off the tap and position it close to the **Wi-Fi HUB**.

Operation

WX1 Tap Timer Manual Operation

1. Tap the **WX1 TAP TIMER** [a] on the **HOME** screen devices list

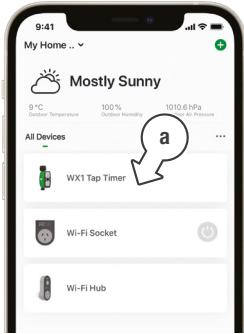

- ❗ This displays **WX1 Tap Timer** controls and settings

2. **LAST WATER USAGE** [b] uses a built-in flow meter within the **WX1**

- ❗ With a **Smart Moisture Sensor** (sold separately) installed, this will display soil moisture and temperature

3. For additional information about your **WX1 Tap Timer**, tap the pencil icon [c]
4. Tap **MANUAL WATERING** [d] to access manual watering controls

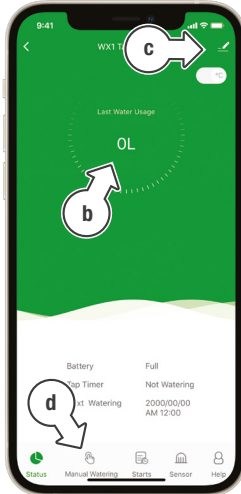

Operation

WX1 Tap Timer Manual Operation (continued)

- ❗ The **MANUAL WATERING** is for one-off watering durations
5. Move the **hollow green circle** [e] on the dial to set the desired watering duration
 6. Press ▶ [f] to start watering and ||| to stop
 7. For automated watering schedules, tap **STARTS** [g]
- ❗ See [Scheduling](#) below for more information on programming
8. For additional data from the **Smart Moisture Sensor**, tap **SENSOR** [h]
- ❗ Manual watering can also be stopped or started at any time using the **TAP TIMER BUTTON**

9. For additional support, tap **HELP** [i]

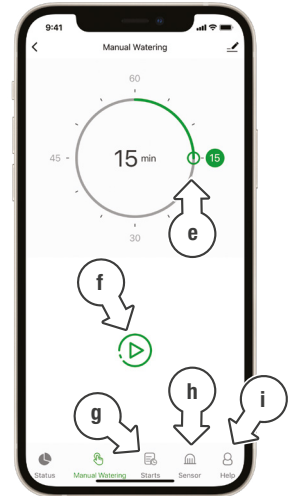

Operation

Wi-Fi Hub and Socket Manual Operation

1. Tap the **Wi-Fi HUB** [a] on the **HOME** screen devices list

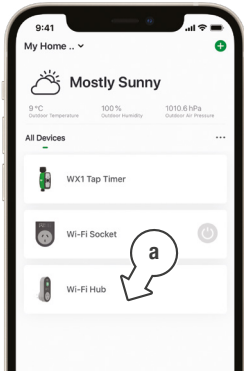

- i** This displays **Wi-Fi Hub** controls and settings
2. To show connected devices to this **Wi-Fi HUB**, tap **ADD/VIEW DEVICES** [b]

3. For additional information about your **Wi-Fi Hub**, tap the pencil icon [c]
4. Tap < [d] to return to the **HOME** screen

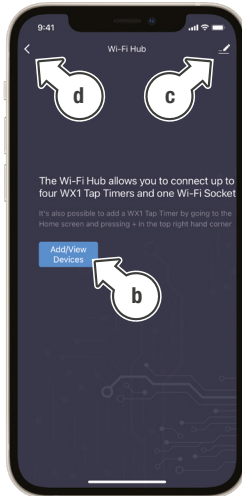

Operation

Wi-Fi Hub and Socket Manual Operation (continued)

5. Tap the **Wi-Fi SOCKET** [e] on the **HOME** screen devices list

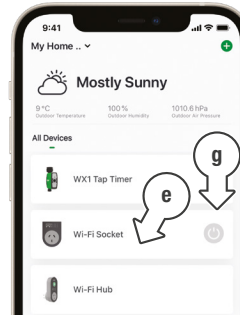

- i** This displays **Wi-Fi Socket** controls and settings
6. Turn the socket power on and off using the **POWER** buttons [f] in Holman Home, or using the **QUICK ON/OFF** [g] on the home page
7. Tap **SCHEDULE** [h] for automated scheduling options

8. For additional information about your **Wi-Fi Socket**, tap the pencil icon [i]

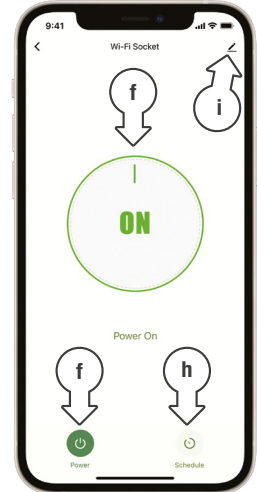

- i** The **Wi-Fi Socket** can also be toggled manually using the **HUB BUTTON** on the **Wi-Fi Hub**

Operation

Wi-Fi Hub and Socket Schedules

1. Tap the **Wi-Fi SOCKET** [a] on the **HOME** screen devices list

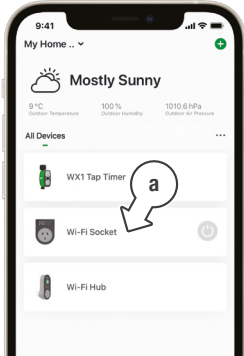

2. On the **Wi-Fi SOCKET** screen, tap **SCHEDULE** [b] for automated scheduling options

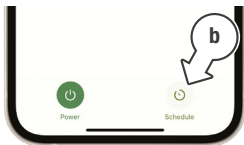

- i** This displays the **Wi-Fi Socket SCHEDULE** screen

3. Tap **ADD** [c] to set up a schedule for the **Wi-Fi Socket**

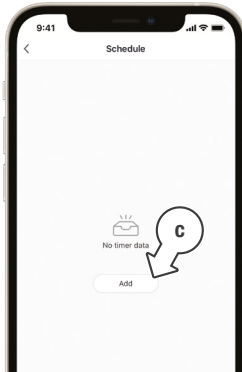

- i** This displays the **ADD SCHEDULE** screen

Operation

Wi-Fi Hub and Socket Schedules (continued)

4. Use the **POWER** menu [d] to choose if the schedule is to switch the **Wi-Fi Socket ON or OFF**
 5. Use the clock wheels [e] to set the desired switch time of day
 6. Tap **REPEAT** [f] to choose which days of the week to toggle the socket
 7. Tap **NOTE** [g] to add a custom description to your schedule
 8. Toggle the **NOTIFICATION** switch [h] to receive alerts when the schedule is triggered
 9. Tap **SAVE** [i] to set your schedule, or **<** [j] to exit without saving
- i** Make sure to set an **ON** and **OFF** time [k] in the **SCHEDULE** screen

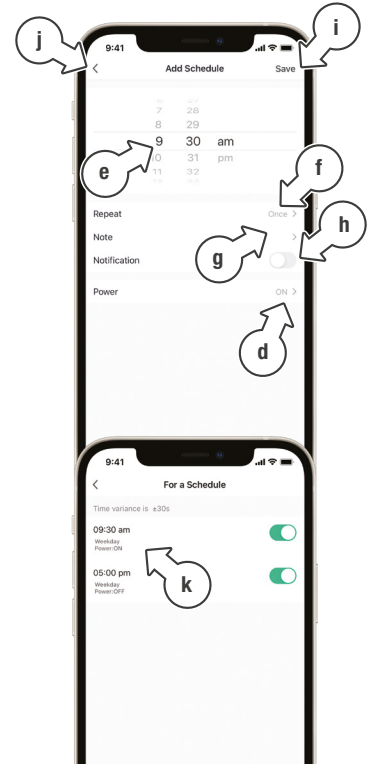

Operation

WX1 Tap Timer Schedules

1. Tap the **WX1 TAP TIMER** on the **HOME** [a] screen devices list

i This displays **WX1 Tap Timer** controls and settings

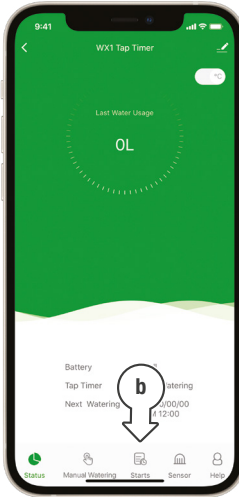
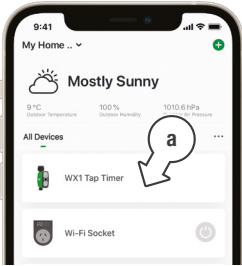

2. Tap **STARTS** [b] to access automated watering controls

i This displays the **STARTS** screen for watering schedules

3. Tap **START A** [c] to set one of three schedules as desired

i This displays **START SETTINGS** for watering schedules

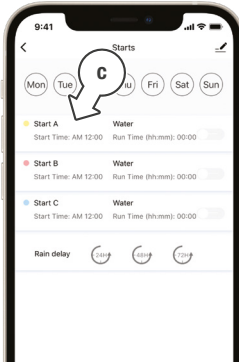

Operation

WX1 Tap Timer Schedules (continued)

4. Use the **24 HOUR TIME** switch [d] to toggle between 24hr and AM/PM time
5. Tap **START TIME** [e] to open the clock and set a start time
6. Tap **RUN TIME** [f] to open the timer and set a watering duration
7. Tap each of the days [g] as required to toggle watering days on or off
8. For shorter watering bursts in intervals tap **MIST** [h]
9. Use **MISTING PERIOD** [i] to set the overall duration of the misting program (11hrs 59s max)
10. Use **MIST TIME** [j] to set the duration for each burst of misting (59s max)
11. Use **INTERVAL** [k] to set the amount of time between each burst (15m 59s max)
12. In either **WATER** or **MIST** mode, tap **SAVE** [l] to set the desired schedule and return to the **STARTS** screen, or tap **<** to return without saving

i This displays **MIST** timing

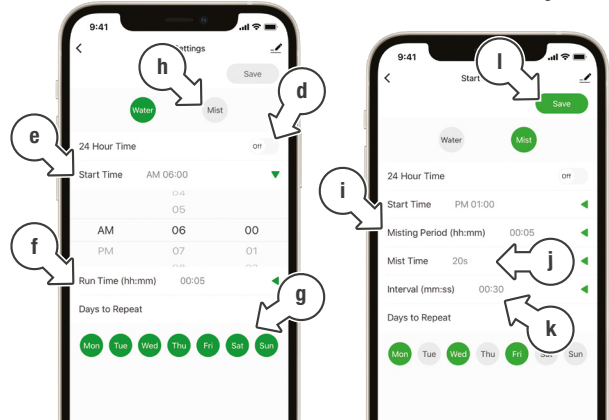

Operation

WX1 Tap Timer Schedules (continued)

- Set additional **STARTS** for **B** and **C** [m] as desired
- As **START SETTINGS** are saved, the scheduled times will show on each **START**
- Watering days will be indicated at the top of the screen [n]
- To manually toggle **START** schedules on or off, use the switches on each start [o]
- To manually toggle **START** schedules on or off, use the switches on each start [o]
- To suspend all watering schedules for a set period of time (ie. during rain), tap **24H**, **48H** or **72H** under **RAIN DELAY** [p] as desired
- Tap **<** [q] to return to the **HOME** screen when setup is complete





Smart Moisture Sensor

Know your garden better than ever by connecting a Smart Water Sensor. This keeps track of soil temperature and moisture, and allows for automatic water restrictions based on moisture sensitivity.



SCAN FOR MORE INFO



Operation

WX1 Tap Timer Smart Automations

- To learn more about Smart Automations, tap on **ME** [a] and tap on **FAQ & Feedback** [b]

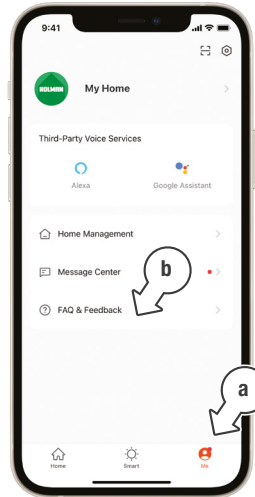

- Tap **How to use the Smart Function** [c] and follow the prompts

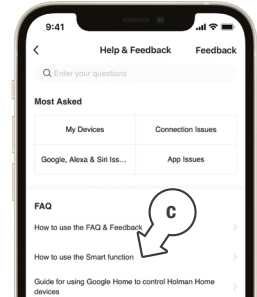

- Tap **WX1 Tap Timer Smart Examples** [d] to read about some of the Smart Automations available with the **WX1 Tap Timer**

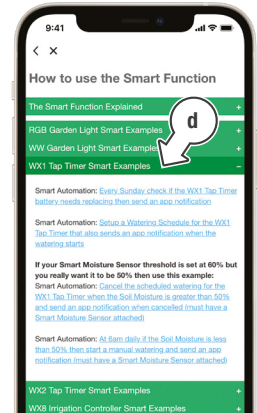

The Smart Function Explained

RGB Garden Light Smart Examples

WW Garden Light Smart Examples

WX1 Tap Timer Smart Examples

Smart Automation: Every Sunday check if the WX1 Tap Timer battery needs recharging then send an app notification

Smart Automation: Set up a Watering Schedule for the WX1 Tap Timer that also sends an app notification when the watering starts

If your Smart Moisture Sensor threshold is set at 60% but you really want it to be 50% then use this example: Smart Automation: Cancel the scheduled watering for the WX1 Tap Timer when the Soil Moisture is greater than 50% and send an app notification when cancelled (must have a Smart Moisture Sensor attached)

Smart Automation: At 8am daily if the Soil Moisture is less than 50% then start a manual watering and send an app notification (must have a Smart Moisture Sensor attached)

WX2 Tap Timer Smart Examples

WX8 Irrigation Controller Smart Examples

Additional Notes

Low Battery Notification

- i** If the batteries need to be replaced, a notification will display [a] in **Holman Home** in the device list—if the **WX1** interface is opened, this will be dismissed
- i** To review the notification:
 - i. Tap **ME** below the **Holman Home** device list [b]
 - ii. Tap **MESSAGE CENTRE** [c] and your **Holman Home** notifications will display as shown [d]
- i** To display these as notifications on your smartphone, ensure notification permissions are enabled for **Holman Home** in your smartphone system settings

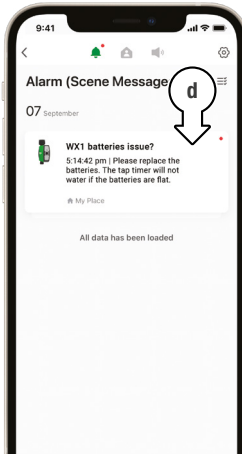
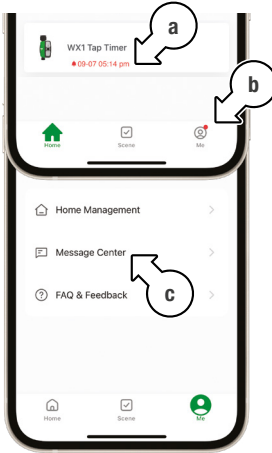

Maintenance

Cold Weather

- i** Your **WX1** should be removed from the tap and stored away during winter if temperatures reach below 4°C
- A** **Keep your tap timer out of freezing conditions as this can damage internal components**

Batteries

- i** Remove batteries from your **WX1** during periods of non-use
- A** **Battery leakage can cause corrosion and damage to your WX1**

Connection Issues

- i** If your **WX1** shows as disconnected after replacing the batteries, please wait a few minutes for **Holman Home** to update your device status
- i** For additional support with connection issues, please contact our **Customer Service** team

Need help? Just ask!

The Holman website has a host of additional information on features. Head to support.holmanindustries.com.au for more tips, tricks and support content.

If you still need help, feel free to email our friendly Customer Service team at support@holmanindustries.com.au or call at [08 9416 9999](tel:0894169999).



Warranty

2 Year Replacement Guarantee

Holman Industries offers a 2 year replacement guarantee with this product.

In Australia our goods come with guarantees that cannot be excluded under the Australian Consumer Law. You are entitled to a replacement or refund for a major failure and compensation for any other reasonably foreseeable loss or damage. You are also entitled to have the goods repaired or replaced if the goods fail to be of acceptable quality and the failure does not amount to a major failure.

As well as your statutory rights referred to above and any other rights and remedies you have under any other laws relating to your Holman product, we also provide you with a Holman guarantee.

Holman Industries guarantees this product against defects caused by faulty workmanship and materials for 2 years domestic use from the date of purchase. During this guarantee period Holman Industries will replace any defective product. Packaging and instructions may not be replaced unless faulty.

In the event of a product being replaced during the guarantee period, the guarantee on the replacement product will expire 2 years from the purchase date of the original product, not 2 years from the date of replacement.

To the extent permitted by law, this Holman Replacement Guarantee excludes liability for consequential loss or any other loss or damage caused to property of persons arising from any cause whatsoever. It also excludes defects caused by the product not being used in accordance with instructions, accidental damage, misuse, or being tampered with by unauthorised persons, excludes normal wear and tear and does not cover the cost of claiming under the warranty or transporting the goods to and from the place of purchase.

Should you suspect your product may be defective and need some clarification or advice please contact us directly:

1300 716 188
support@holmanindustries.com.au
11 Walters Drive,
Osborne Park 6017 WA

If you are certain your product is defective and is covered by the terms of this warranty, you will need to present your defective product and your purchase receipt as proof of purchase to the place you purchased it from, where the retailer will replace the product for you on our behalf.



**Thanks for being a
#SMARTGARDENER**



**We really appreciate having you as a customer, and
would like to say thank you for choosing us.**

We recommend registering your new product on our website. This will ensure we have a copy of your purchase and activate an extended warranty. Keep up to date to with relevant product information and special offers available through our newsletter.

www.holmanindustries.com.au/product-registration/



HOLMAN

For the #SMARTGARDENER   

Copyright © 2021 Holman Industries