

INSTRUCTION MANUAL

SOLAR POWERED DIGITAL TAP TIMER



Solar Powered

HOLMAN

EVO 1001

3 year warranty

Solar panel
Solar powered - no batteries required. Charge the timer in daylight for about an hour before programming. Operates day and night in any location or weather condition.

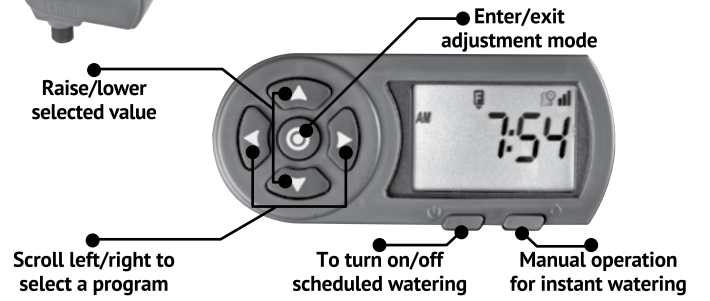

PROGRAmmING ICONS

- CURRENT TIME DATE
- SET DAYS
- START TIME
- RUN TIME
- RAIN DELAY
- MANUAL RUN
- CURRENTLY WATERING
- SENSOR ACTIVE
- CURRENT POWER LEVEL

Operating pressure: 70kPa-680kPa • Flow rate: .38-30L/M
For irrigation use only

HOW TO INSTALL

Attach the timer inlet to the outdoor faucet/spigot turning clockwise – hand tighten only. From the timer outlet connect a drip irrigation system or a garden hose.

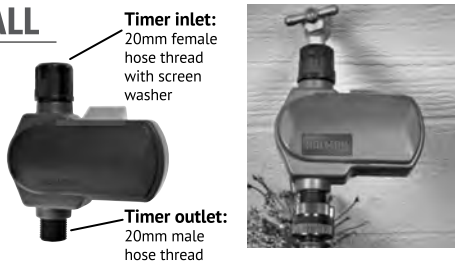

MAINTENANCE

- Remove and clean the screen washer on inlet side of the timer every few months.
- In freezing conditions, uninstall the timer and bring it indoors to prevent damage.

A SETTING – TIME & DATE



Set the current time and date

Push to select the hour and adjust using .
AM/PM is set by increasing or decreasing the hour.

Continue to push to set the minutes, and current month, day, then year.

Push to confirm your settings.

B SETTING – WATERING DAYS

watering - Specific days of the week



watering day

Non-watering day

Push to select Set Days . By default all days are set to water.
Push and advance through days of the week using . Deselect or select a day to water using .

Push to confirm your settings.

watering - Odd/Even days

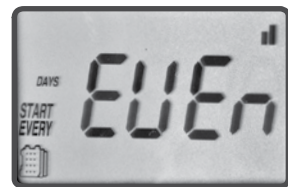

Push to select Set Days .

Push and advance through days of the week using until EVEN appears flashing. Push to select ODD. Push to confirm your settings.

Restore to factory default settings:

Push to select Set Days . Push and hold for three seconds. Default settings will be restored but current time and date will be retained.

watering - Every X days (Cyclical watering)

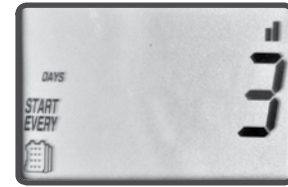

Push to select Set Days .

Push and advance through days of the week using until 1 DAY appears flashing. Push to select to water once every 1 to 30 days.
Push to confirm your settings.

To set the timer back to specific days mode:

Push to select Set Days .

Push and then push until the days of the week can be seen at the top of the LCD screen. Push and advance through days of the week using and select each day to water using . Push to confirm your settings.

C SETTING – START TIMES



Push to select Start Time . By default Start Time 1 is set to 6:00 AM.
Push to select the hour and adjust using then push to set minutes. To set additional start times push . Up to 4 start times can be programmed. Push to confirm your settings.
View all set start times by pressing .

To delete a start time:

Push to select the hour then push to advance or decrease the hours until the display shows OFF. Push to confirm your settings.

USING A SENSOR (SENSOR NOT INCLUDED)

The purpose of using a sensor is to prevent automatic watering by the set program due to excessive rainfall. Most "normally closed" rain sensors can be used with the EVO 1001 timer.

- Cut the yellow wire loop in the center and splice to each of the sensor wires using **waterproof wire connectors**.
- Follow the sensor manufacturer's instructions for calibrating the sensor.
- When the sensor is active and preventing watering, the icon will appear.

D SETTING – RUN TIMES



Push to select Run Time . By default the Run Time is set to 5 min.
Push to select the hour and adjust using then push to set minutes. Push to confirm your settings.

E SETTING – RAIN DELAY

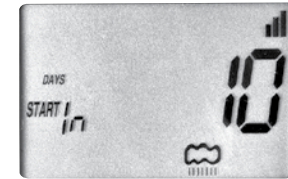

Used to shut down timer in winter or when it is raining. Set schedules will be retained and programmed watering will resume after the delay time is completed.
Push to select Rain Delay . Push then adjust to the number of days to suspend watering using . Push to confirm your settings.
To cancel the Rain Delay, set the days to OFF using .

F MANUAL RUN

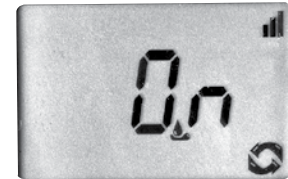

To instantly water push .

Push to stop or the timer will run for the programmed time (if set).
Default watering time is 5 min.

